

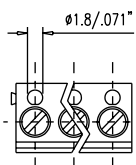

305-031-12

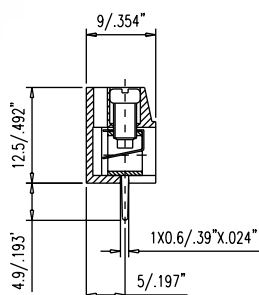
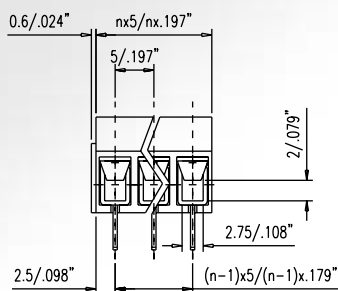

Recommended P.C.B. Holes
diameter : $\phi 1.2\text{mm}$ to $\phi 1.4\text{mm}$
n= number of contacts

** To avoid accumulated
tolerance-variations
of Terminal-Blocks to
PC-Board spacing,
limit the number of
contacts to not more
than 24 contacts per row.



305-031-12



SERIES 305

Terminal Blocks For PC-Boards Stamping Type Insert

Front Wire Inlet Type - Screw On Top
Spacing 5mm or 10mm
Height Over PC-Board 12.5mm

Technical Data

Material

- Contact:
(metal housing) Brass (Cu Zn)
Cu/Ni, tin plated
- Terminal screw: Steel galvanized
and chromated
Cu Sn 6
- Wire guard:
- Surface
of solder tail: Tin plated
- Insulator body:
(housing) Poly Butylene
Terephthlene,
PBT (30% Glass filled)
(UL 94 V-0)

Electrical

- Current rating: 16 Amp
- Resistance to tracking: 5M Ω
- Dielectric strength: 2500V
- Insulation withstands
voltage: AC 1500V/Min
- Rated voltage: 300V
- Rated cross section: 2.5mm²
- Rated cross range
With wire guard: 2.5mm²
Without wire guard: 4.0mm²
- AWG: 22 - 14
- Stripping length: 4.5 - 5mm

Mechanical

- Operating
temperature: -30°C to + 120°C
- Short time peak
temperature: +200°C max

HOW TO ORDER :

3	0	5	—	X	X	X	—	X	X
Series No.			No. of Pole		Pitch	Wire Guard		Color	
					1 5mm	1 With		1 Grey	
					2 10mm	2 Without		2 Blue	
								3 Black	